

FUNDATII STALPI ELECTRIFICARE
POWER POLE FOUNDATION
SCARA/ SCALE 1:20

PLAN FUNDATIE STALP ELECTRIFICARE
POWER POLE FOUNDATION PLAN

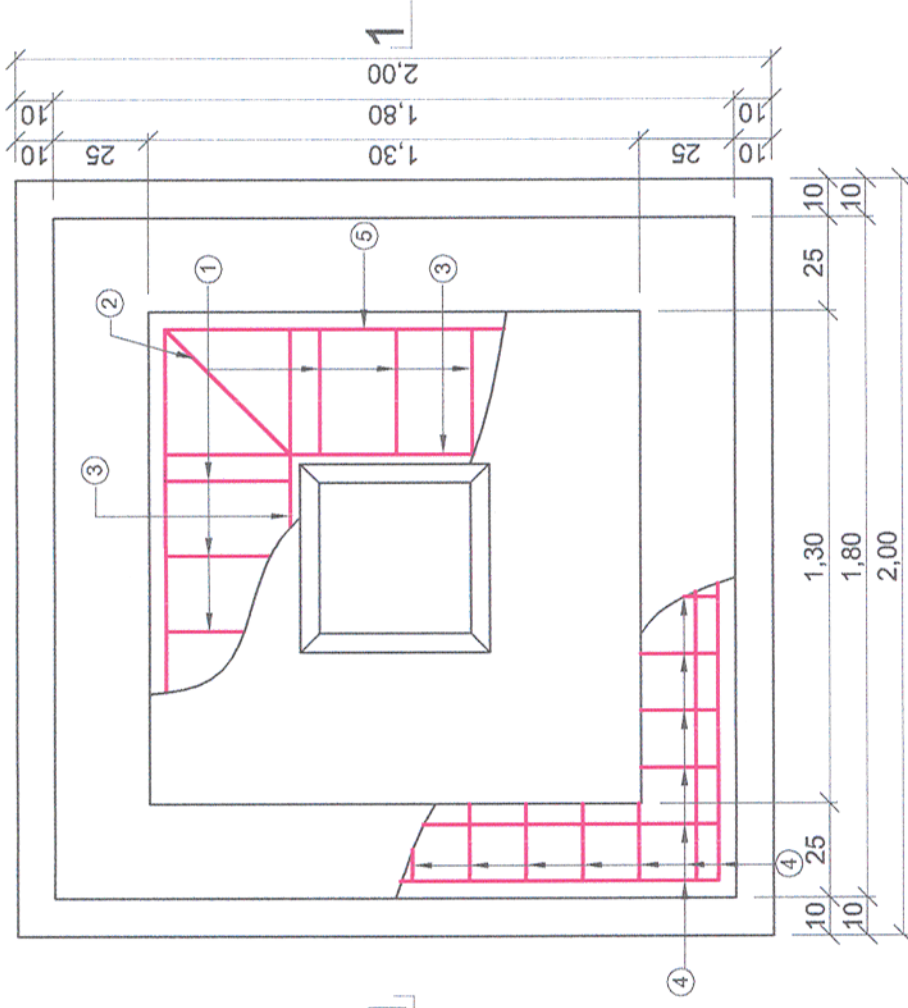

① Ø10/20 Bst500 L=3.65m ② Ø10 Bst500 L=3.80m

③ Ø10/10 Bst500 L=1.55m

④ Ø10/10 Bst500 L=1.70m

⑤ Ø10/10 Bst500 L=5.15m

⑥ Ø10/10 Bst500 L=5.15m

⑦ Ø10/10 Bst500 L=5.15m

⑧ Ø10/10 Bst500 L=5.15m

⑨ Ø10/10 Bst500 L=5.15m

⑩ Ø10/10 Bst500 L=5.15m

⑪ Ø10/10 Bst500 L=5.15m

⑫ Ø10/10 Bst500 L=5.15m

⑬ Ø10/10 Bst500 L=5.15m

⑭ Ø10/10 Bst500 L=5.15m

⑮ Ø10/10 Bst500 L=5.15m

⑯ Ø10/10 Bst500 L=5.15m

⑰ Ø10/10 Bst500 L=5.15m

⑱ Ø10/10 Bst500 L=5.15m

⑲ Ø10/10 Bst500 L=5.15m

⑳ Ø10/10 Bst500 L=5.15m

㉑ Ø10/10 Bst500 L=5.15m

㉒ Ø10/10 Bst500 L=5.15m

㉓ Ø10/10 Bst500 L=5.15m

㉔ Ø10/10 Bst500 L=5.15m

㉕ Ø10/10 Bst500 L=5.15m

㉖ Ø10/10 Bst500 L=5.15m

㉗ Ø10/10 Bst500 L=5.15m

㉘ Ø10/10 Bst500 L=5.15m

㉙ Ø10/10 Bst500 L=5.15m

㉚ Ø10/10 Bst500 L=5.15m

㉛ Ø10/10 Bst500 L=5.15m

㉜ Ø10/10 Bst500 L=5.15m

㉝ Ø10/10 Bst500 L=5.15m

㉞ Ø10/10 Bst500 L=5.15m

㉟ Ø10/10 Bst500 L=5.15m

㊱ Ø10/10 Bst500 L=5.15m

㊲ Ø10/10 Bst500 L=5.15m

㊳ Ø10/10 Bst500 L=5.15m

㊴ Ø10/10 Bst500 L=5.15m

㊵ Ø10/10 Bst500 L=5.15m

㊶ Ø10/10 Bst500 L=5.15m

㊷ Ø10/10 Bst500 L=5.15m

㊸ Ø10/10 Bst500 L=5.15m

㊹ Ø10/10 Bst500 L=5.15m

㊺ Ø10/10 Bst500 L=5.15m

㊻ Ø10/10 Bst500 L=5.15m

㊼ Ø10/10 Bst500 L=5.15m

㊽ Ø10/10 Bst500 L=5.15m

㊾ Ø10/10 Bst500 L=5.15m

㊿ Ø10/10 Bst500 L=5.15m

SECTIUNE /SECTION 1-1

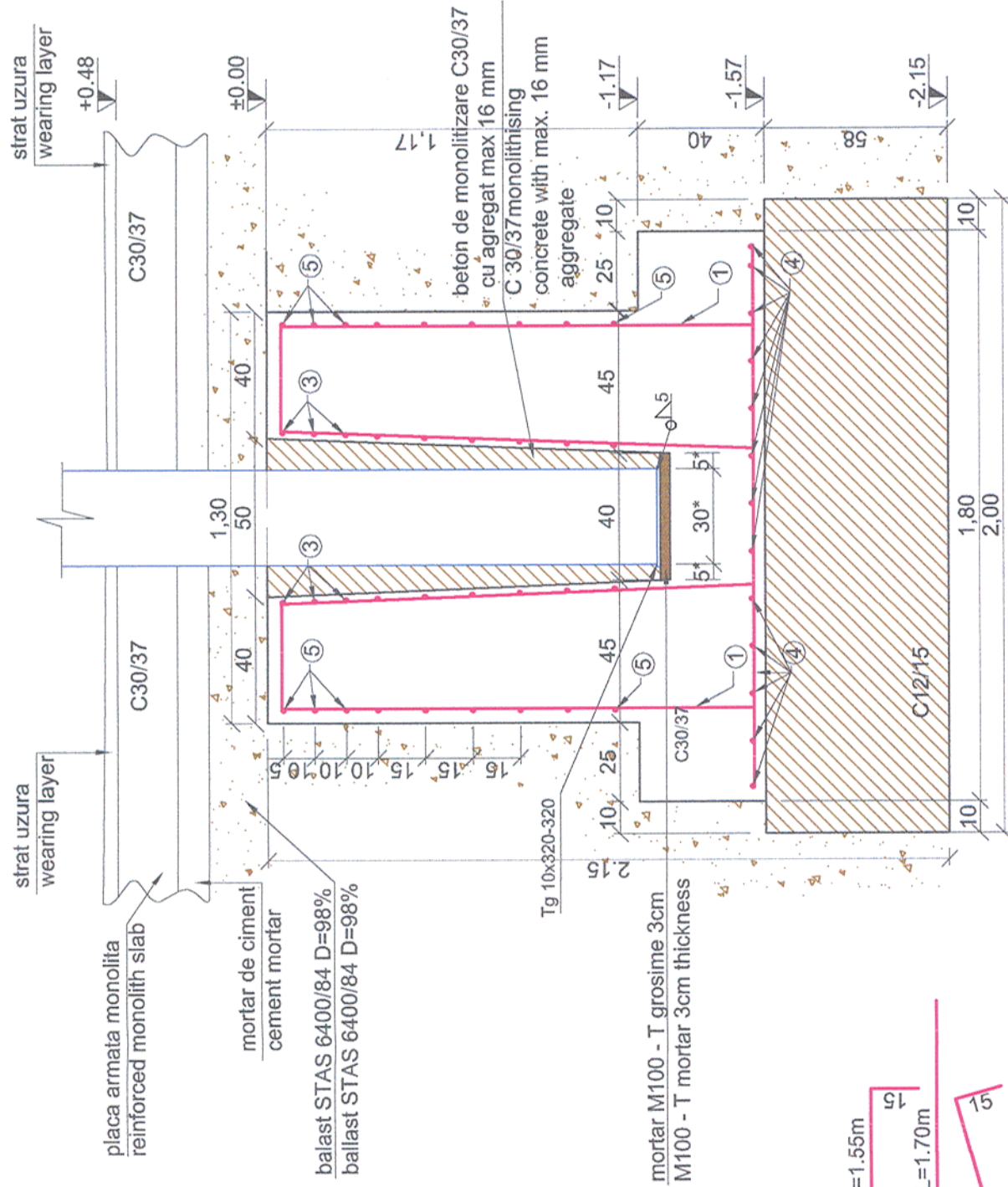

Cotele notate cu * vor fi adaptate pe teren in functie de dimensiunile stalpului
The quotas marked with * will be adapted on field, function of the pole's dimensions

Nr.	Diam	Lungime	Buc.	Bst500(S550)
1	10	3.65	12	43.80
2	10	3.80	4	15.20
3	10	1.55	36	55.80
4	10	1.70	26	44.20
5	10	5.15	9	46.35
LUNGIMI/diam				205.4
Greutati Diam/ml				0.616
Greutati Kg/diam				126.5
TOTAL pe tip otel				126.5
TOTAL GENERAL				126.5

Toate tipurile de otel (In special Bst 500) vor avea obligatoriu clasa de ductilitate C.
All types of steel (especially Bst 500) will mandatory have the ductility class C.

Acest plan anuleaza si inlocuieste planul nr. PT.02.04.02.RE.01.010 elaborat la data 01.2013.

This layout plan canceled and replaced layout plan no. PT.02.04.02.RE.01.010 prepared on 01.2013.

 Beneficiar / BENEFICIARY : COMPANIA NATIONALA DE CAI FERATE "CFR" SA		 PROIECTANT / DESIGNER:	Data Date	Semnatura Signature
Verificator / Expert Checker / Expert	Cerinta Requirement	Semnatura Signature	Referat / Expertiza Report / Expertise	 COMPANIA NATIONALA DE CAI FERATE "CFR" SA
European Investment Bank		MINISTERUL TRANSPORTURILOR		 COMPANIA NATIONALA DE CAI FERATE "CFR" SA
Aprobata / Approved		Sef de echipa / Team leader	C. Teodorescu	01.2013
Verificata / Checked		Expert Cheie / Key Expert	R. Witan	01.2013
Subcontractant / Subcontractor				
Aprobata / Approved		Adjunct Sef de echipa / Deputy Team leader	A.M. Baicu	01.2013
Proiectata / Designed		Inginer / Engineer	S. Petrea	01.2013
"Reabilitarea liniei c.f. Frontiera - Curtici - Simeria, parte componenta a coridorului IV Pan - European pentru circulatia trenurilor cu viteza maxima de 160 km/h" "Rehabilitation of the Railway Line Border - Curtici - Simeria, component Part of the IV Pan - European Corridor for the Trains Circulation with maximum speed of 160 km/h" Section 2 - A: km 614 - End Y Bärzava				
Denumire desen / Drawing name:				
Fundatii stilpi electrificare Ghiroac/Ghiroac power pole foundation				
Scara / Scale	Revizia / Revision	Cod desen / Drawing Code	Nr / No	10/10
1:20	1/05.2013	PT.2A.03.02.RE.01.010		